

## KMDA 7476 FL

Induction hob with integrated vapour extraction

with two extra large PowerFlex XL cooking areas and flush-fit vapour extraction



- Ample space – 4 large cooking zones incl. 2 PowerFlex XL areas
- Elegant design – flush fit downdraft extractor
- Automatic fan power regulation – Con@ctivity
- Compact control using the numerical display – ComfortSelect Plus
- Energy-efficient and quiet – powerful ECO motor

**A++**

EAN: 4002516451020 / Material number: 11789940 / Old Material Number: 26747672GB

<b>Heating type</b>	
Heating type on the left	Electric with induction
<b>Operating modes</b>	
Type of air guide	Convertible
Recirculation conversion kit (order separately)	DUU 1000-2
Flat ducting components (order separately)	DFK- xxxx
<b>Design</b>	
Elegant glass ceramic surface	•
Flush	•
Ceramic surface colour	Black
Frameless – surface-mounted	•
Flush fit extractor	•
<b>Cooking zone details</b>	
Number of cooking zones	4
Number of cooking areas	2
Maximum number of pans	4
<b>PowerFlex cooking zones</b>	
No.	4
Type	PowerFlex XL-Kochzone
Size in mm	150x230
Max. rating in W	2.10
Max. Booster power rating in W	3.00
Max. TwinBooster power rating in W	3650
<b>1st cooking zone/cooking area</b>	
Position	Left
Max. rating in W	3400
Max. Booster power rating in W	4800
Max. TwinBooster power rating in W	7300
<b>2nd cooking zone/cooking area</b>	
Position	right
Max. rating in W	3400
Max. Booster power rating in W	4800
Max. TwinBooster power rating in W	7300
<b>User convenience</b>	
Networking with Miele@home	•
Automatic function Con@ctivity 3.0	•
Digital power level display	•
Display colour	Yellow
Operation via sensor controls	ComfortSelect Plus
Auto heat-up	•
Permanent pan recognition	•
Recall function	•
Safety switch-off	•
Individual setting options (e.g. buzzers)	•
Run-on time 5/15 min.	•
Active charcoal filter saturation indicator	•
Stop & Go function	•
Grease filter saturation indicator	•
Minute minder	•
Keeping warm	•

KMDA 7476 FL

Induction hob with integrated vapour extraction

with two extra large PowerFlex XL cooking areas and flush-fit vapour extraction



EAN: 4002516451020 / Material number: 11789940 / Old Material Number: 26747672GB

<b>Efficiency and sustainability</b>	
Energy efficiency class (A+++ to D)	A++
Annual energy consumption in kWh/year	27.6
Fluid dynamic efficiency class	A
Lighting efficiency class	-
Grease filtering efficiency class	A
ECO motor	•
<b>Cleaning convenience</b>	
Easy to clean ceramic glass	•
Wipe protection	•
Easy-to-clean canopy interior – CleanCover	•
<b>Filter system</b>	
Number of dishwasher safe stainless-steel grease filters (10-ply)	1
<b>Extraction</b>	
Air throughput in Level 1 (m <sup>3</sup> /h) according to EN 61591	160
Air throughput in Level 2 (m <sup>3</sup> /h) according to EN 61591	330
Air throughput in Level 3 (m <sup>3</sup> /h) according to EN 61591	490
Air throughput in Intensive level (m <sup>3</sup> /h) according to EN 61591	580
Sound power in Level 1 (dB(A) re 1 pW) according to EN 60704-3	45.0
Sound power in Level 2 (dB(A) re 1 pW) according to EN 60704-3	60.0
Sound power in Level 3 (dB(A) re 1 pW) according to EN 60704-3	69.0
Sound power in Booster level (dB(A) re 1 pW) acc. to EN 60704-3	73.0
Sound pressure in Level 1 (dB(A) re 20 µPa) according to EN 60704-2-13	31.0
Sound pressure in Level 2 (dB(A) re 20 µPa) according to EN 60704-2-13	47.0
Sound pressure in Level 3 (dB(A) re 20 µPa) according to EN 60704-2-13	56.0
Sound pressure in Booster level (dB(A) re 20 µPa) acc. to EN 60704-2-13	60.0
<b>Recirculation</b>	
Air throughput in Level 1 (m <sup>3</sup> /h) according to EN 61591	105
Air throughput in Level 2 (m <sup>3</sup> /h) according to EN 61591	255
Air throughput in Level 3 (m <sup>3</sup> /h) according to EN 61591	410
Air throughput in Booster level (m <sup>3</sup> /h) according to EN 61591	510
Sound power in Level 1 (dB(A) re 1 pW) according to EN 60704-3	43.0
Sound power in Level 2 (dB(A) re 1 pW) according to EN 60704-3	60.0
Sound power in Level 3 (dB(A) re 1 pW) according to EN 60704-3	70.0
Sound power in Booster level (dB(A) re 1 pW) acc. to EN 60704-3	76.0
Sound pressure in Level 1 (dB(A) re 20 µPa) according to EN 60704-2-13	29.0

## KMDA 7476 FL

Induction hob with integrated vapour extraction

with two extra large PowerFlex XL cooking areas and flush-fit vapour extraction



EAN: 4002516451020 / Material number: 11789940 / Old Material Number: 26747672GB

Sound pressure in Level 2 (dB(A) re 20 µPa) according to EN 60704-2-13	47.0
--	------

Sound pressure in Level 3 (dB(A) re 20 µPa) according to EN 60704-2-13	56.0
--	------

Sound pressure in Booster level (dB(A) re 20 µPa) acc. to EN 60704-2-13	62.0
---	------

### Safety

Safety switch-off	•
-------------------	---

Lock function	•
---------------	---

System lock	•
-------------	---

Integrated cooling fan	•
------------------------	---

Overheating protection	•
------------------------	---

Residual heat indicator	•
-------------------------	---

### Technical data

Dimensions in mm (width)	800
--------------------------	-----

Dimensions in mm (height)	200
---------------------------	-----

Casing height incl. connection box in mm	200
--	-----

Dimensions in mm (depth)	520
--------------------------	-----

Cutout dimensions in mm (width) with surface-mounted installation	780
---	-----

Cutout dimensions in mm (depth) with surface-mounted installation	500
---	-----

Internal cutout dimensions in mm (depth) with flush installation	500
--	-----

Weight in kg	20
--------------	----

External cutout dimensions in mm (width) with flush installation	804
--	-----

External cutout dimensions in mm (depth) with flush installation	524
--	-----

Total rated load in kW	7.50
------------------------	------

Internal cutout dimensions in mm (width) with flush installation	780
--	-----

Voltage in V	230
--------------	-----

Frequency in Hz	50-60
-----------------	-------

Length of supply lead in m	1
----------------------------	---

### Accessories supplied

Number of mains cables with plug	Yes
----------------------------------	-----

## KMDA 7476 FL

Induction hob with integrated vapour extraction  
with two extra large PowerFlex XL cooking areas and flush-fit vapour extraction

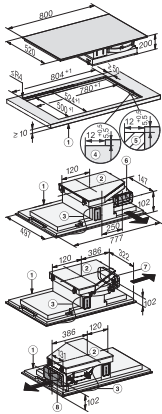

KMDA 7633 FL, KMDA 7634 FL, KMDA 7476 FL, KMDA 7271 FL – flush (Installation drawing)

1) Front, 2) The removable drip tray must be accessible after installation. , 3) Mains connection box with mains connection cable, L = 1440 mm, 4) Stepped cut-out, 5) Wooden support frame (not supplied with the appliance), 6) Duct connection at rear >220-222 x 89-90 / R1-R19 (machine delivered with this option), 7) Duct connection to the right >220-222 x 89-90 / R1-R19 (requires conversion), 8) Duct connection to the left >220-222 x 89-90 / R1-R19 (requires conversion)

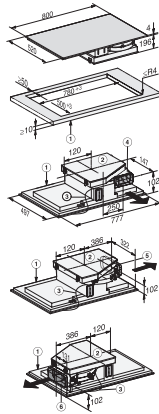

KMDA 7633 FL, KMDA 7634 FL, KMDA 7476 FL, KMDA 7271 FL – frameless supported (Installation drawing)

1) Front, 2) The removable drip tray must be accessible after installation. , 3) Mains connection box with mains connection cable, L = 1440 mm, 4) Duct connection at rear >220-222 x 89-90 / R1-R19 (machine delivered with this option), 5) Duct connection to the right >220-222 x 89-90 / R1-R19 (requires conversion), 6) Duct connection to the left >220-222 x 89-90 / R1-R19 (requires conversion)