

M 2240 SC

Built-in microwave oven
with sensor controls on the side for convenient operation.



- 7-segment display with sensor controls – EasySensor
- Perfect defrosting and cooking – Automatic programmes
- Food remains at serving temperature – keeping warm function
- Compact – 26 l oven compartment volume

EAN: 4002516103332 / material number: 11093910

| Model and design | |
|----------------------------------|----------------------------|
| Built-in microwave oven | • |
| SideControl | • |
| Appliance colour | Obsidian black |
| Convenience features | |
| Keeping warm | • |
| Operating modes | |
| Microwave solo operation | • |
| User convenience | |
| Display | EasySensor |
| Time of day display | • |
| Minute minder | • |
| Programmable cooking duration | • |
| Quick microwave | • |
| Individual settings | • |
| Cleaning convenience | |
| Stainless steel oven compartment | • |
| Safety | |
| System lock | • |
| Safety switch-off | • |
| Safety lock "Door" warning | • |
| Technical data | |
| Oven compartment volume in l | 26 |
| Door hinge | Left |
| Oven light | 1 LED spot |
| Oven interior height in cm | 20.7 |
| Turntable diameter in cm | 32.5 |
| Microwave power levels in W | 80/150/300/450/600/750/900 |
| Appliance width in mm | 595 |
| Appliance height in mm | 452 |
| Appliance depth in mm | 401 |
| Weight in kg | 18.0 |
| Niche-independent venting | • |
| Total rated load in kW | 1.4 |
| Voltage in V | 220-240 |
| Frequency in Hz | 50 |
| Number of phases | 1 |
| Fuse rating in A | 13 |
| Length of supply lead in m | 1.6 |

M 2240 SC

Built-in microwave oven
with sensor controls on the side for convenient operation.

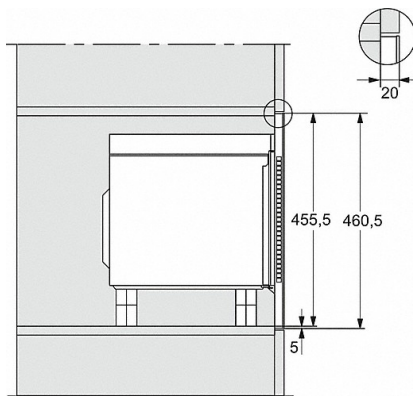

M2240SC, installation drawing

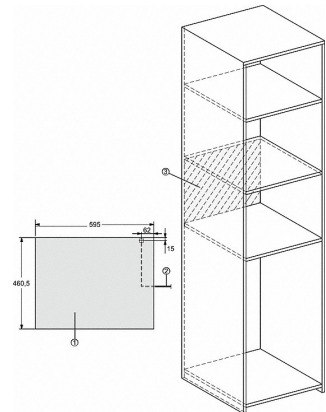

M2240SC, installation drawings

- 1) Front view
- 2) Mains connection cable L=1,600 mm
- 3) No connection in this area

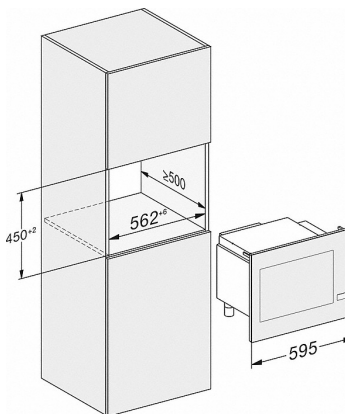

M2240SC, installation drawings