

Cleaning and care

Cleaning the central spout

Clean the central spout's stainless steel cover **by hand** only.

- Open the appliance door.

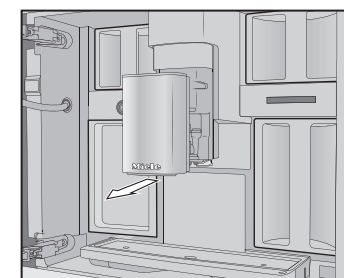

- Remove the central spout's stainless steel cover and clean it.

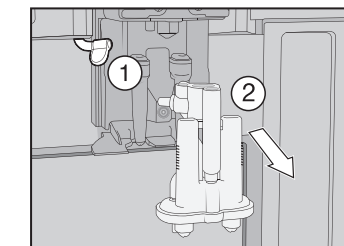

- Detach the milk pipework from the dispensing unit ①. Pull the dispensing unit down to remove it ②.

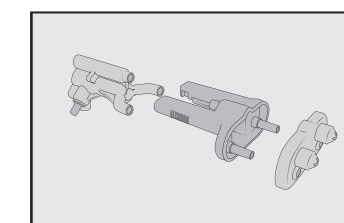

- Take the dispensing unit apart, separating it into 3 components.
- Clean all parts thoroughly. Clean the surfaces of the central spout with a damp cloth.

- Fit the dispensing unit back together.
- Push the dispensing unit back into the central spout and replace the stainless steel cover.
- Confirm the message with OK.

Removing the brew unit and cleaning it by hand

Only clean the brew unit **by hand** with warm water. **Do not use any cleaning agents.**

- Open the appliance door and remove the water container.

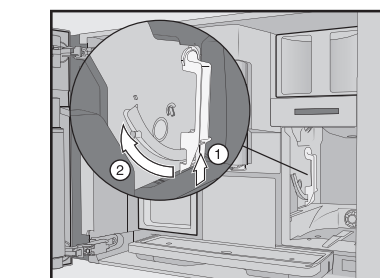

- Press the button under the handle of the brew unit ① and, whilst doing so, turn the handle forwards ②.

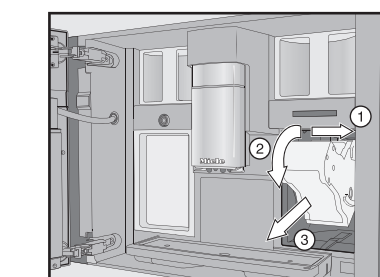

- First, pull the brew unit sideways ① and then slide it out forwards ②. Tilt the brew unit forwards ③.

When you have removed the brew unit, do not change the position of the handle on the brew unit.

- Clean the brew unit **by hand** under warm running water.

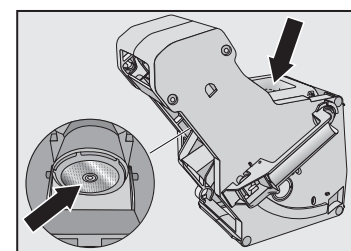

- Wipe any remaining coffee off the filters (see arrows).
- Dry the funnel in the brew unit.
- Carefully clean the inside of the coffee machine.
- Push the brew unit back into the coffee machine.
- Lock the brew unit. Press and hold the button under the brew unit handle and, whilst doing so, turn the handle to the right.
- Close the appliance door.
- Follow the further instructions given in the display.

The process is complete when rinsing has finished.

Descaling the appliance

You will need **2** descaling tablets for the descaling programme.

The **Descal** the appliance message appears in the display.

- Touch OK.

The maintenance programme will then start.

- Follow the instructions in the display.

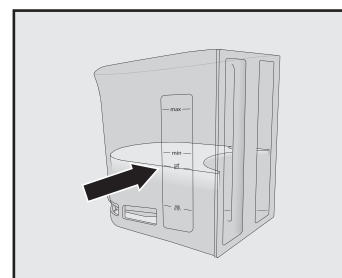

- Fill the water container to the descaling symbol with lukewarm water.
- Drop **2** descaling tablets in the water.
- Push the water container back into the machine.
- Follow the further instructions given in the display.

When **Rinse** the water container and fill with fresh water to the descaling symbol appears in the display:

- Remove the water container and rinse it thoroughly with clean water. Fill the water container to the descaling symbol with fresh tap water.

The descaling process is complete when rinsing has finished.

Coffee the way you like it

Bean system

You can change the names for the types of coffee bean and/or reallocate the types of bean under **Settings** | **Type of beans**.

If you do not allocate a type of bean, you will be asked what type of bean you want to use for the coffee as you make it.

Renaming the type of beans

The 3 bean containers are shown in the display as follows and are pre-named.

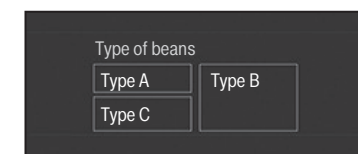

If you are using the same type of beans in two or three bean containers at the same time (for instance because you only use one type of bean), make sure you name them in exactly the same way.

- Select **Change name**.
- Enter the name you want and then touch **Save**.

Allocating types of beans

- Select **Change allocation**.
- If you have set up at least 1 profile and at least 1 coffee drink, first select the profile.
- Change the allocation as required and then confirm with **OK**.

Tip: If you tap **All drinks**, you will highlight all coffee drinks and you can deselect the ones you do not want.

The descaling process is complete when rinsing has finished.

Drink parameters

You can set the quantity of coffee, the brewing temperature and pre-brewing for each drink individually.

- Touch the drink you want and keep your finger on it until the context menu opens.

- Touch **Change drink** and select a drink.

- Touch **Drink parameters**.

- Select **Quantity of coffee**, **Brew temperature**, **Pre-brewing** or **Type of beans**.

- Select the setting you want and touch **OK**.

- Touch **OK** again to save your changed settings.

Portion size

You can adjust the portion size for all coffee drinks, hot water, all types of tea and drinks with milk.

- Place a cup under the central spout.

- Touch the drink you want and keep your finger on it until the context menu opens.

- Touch **Portion size**.

The drink will be made and **Save** will appear in the display as soon as the minimum dispensing amount is reached.

- When the cup is filled up to the level you want, touch **Save**.

If you want to change the portion size for coffee drinks made with milk or hot water, the ingredients which make up the drink will be saved one after the other while the drink is being made.

Performance mode

You can select the appropriate mode to suit your personal preferences under **Settings** | **Performance mode**. The energy consumption varies depending on the selected mode.

- **Eco mode:** This is an energy-saving mode.

- **Barista mode:** This mode is optimised for espresso and coffee drinks.

- **Latte mode:** In this mode, milk-based drinks can be prepared within a much shorter space of time.

In addition, you can activate **Party mode** for the occasional intensive use of the coffee machine, e.g. for family get-togethers (see the operating instructions).

Profiles

In addition to the Miele drinks menu (Miele profile), you can create individual profiles to cater for different tastes and preferences.

Creating a profile

- Select **Profiles** followed by **Create profile**. The editor will open in the display.
- Enter the name you want and then touch **Save**.

The profile has been created. You can now create a drink.

Once you have created some drinks, you can edit these entries in the context menu.

Processing a profile

Once you have created 1 profile, you can rename, delete or move profiles via the context menu.

Setting when the profile should change

You can choose between the following options:

- **Manually:** the selected profile will remain active until you select another profile.

- **After each use:** The machine will revert to the Miele profile whenever a drink is dispensed.

Creating and processing drinks in a profile

You can create new drinks based on existing drinks. A profile can contain a maximum of 9 drinks.

- Start by accessing the profile you want as follows: touch **Profiles** and select the profile.

- Touch **Create drink** and select a drink.
- Change the portion size or drink parameters.

Preparation will begin and you can save the portions of each component as desired.

- Enter a name for the new drink and touch **Save**.

Once you have created some drinks, you can edit these entries in the context menu.

Settings

You can personalise your coffee machine by adapting the factory default settings to suit your requirements.

Factory default settings are marked in *italics*.

Language

- German | ... other languages
- Location

Time

- Display: On | Off | Night dimming
- Clock display: Analogue | Digital
- Clock format: 24 h | 12 h (am/pm)

- Set

Tip: If you touch the time of day on the top right of the display, you can set the time directly.

Date

- The date appears if the **Time** | **Clock type** | **Digital** setting is selected.

Status display

- Main menu | **Drinks** | **Profiles** | **MyMiele**

Select the menu that is displayed when the coffee machine is switched on.

Timer

- Appliance timer: Switch on at | Switch off at | Switch off after (0:20)
- TeaTimer: Automatic | *Manual*
- Maintenance Timer

Volume

- Buzzers
- Keypad tones

Display

- Brightness
- Colour scheme: Bright | *Dark*
- QuickTouch: On | Off

Lighting

You can use the sensor control to switch the lighting on or off at any time, provided that the coffee machine is switched on.

If the coffee machine is switched off, you can still switch the lighting on or off whenever you like but you will need to select the following settings first:

- Time | Display | On or Night dimming (time of day is displayed)
- Display | QuickTouch | On

Info

- Number of portions (Total no. of portions | Total coffees | ...)
- No. of portions until maintenance programme: **Descal** the appliance | **Degrease** the brew unit

- Fill levels (of cartridges)

Fresh water (CVA 7845)

- On | Off

Altitude

- 0–250 m, 251–500 m, ...

Performance mode

- *Eco mode* | **Barista mode** | **Latte mode** | **Party mode**

Party mode is a Performance mode for the occasional intensive use of the coffee machine (see the operating instructions).

Water hardness

- Set to 21 °dH by default.

Automatic cleaning

- On | Off

Type of beans

- Type A, B and C: Change name | Change allocation

Movement sensor

- Switch on the light: Appliance switched on (On | Off) | Appliance switched off (On | Off)

- Switch on the appliance: On | Off
- Acknowledge buzzers: On | Off

System lock

- On | Off

When the system lock is activated, the **Switch on at** option for the timer and the movement sensor cannot be selected.

Miele@home

- Setup | Deactivate/activate | Connection status | New setup

- Remote control (On | Off)

- SuperVision: SuperVision display (On | Off), display in Standby mode (On | Off), appliance list

- RemoteUpdate (On | Off)

Some menu options only appear if Miele@home has been set up and the coffee machine has – where applicable – been connected to a WiFi network.

Software version

- For the Customer Service Department

Legal information

- Open source licences

Showroom

- Demo mode: On | Off

Factory default settings

- Appliance settings

Language, Time, Date, Number of portions, Miele@home settings, Profiles and the corresponding drinks cannot be reset.

The Maintenance Timer is reset to 2 am.

- MyMiele

Miele

Quick Start Guide Coffee machine



These short instructions are **not** a substitute for the operating instructions supplied with the machine. It is essential to familiarise yourself with the coffee machine before using it for the first time. Please read the operating instructions carefully and pay particular attention to the Warning and Safety instructions.

Operation

Touch display

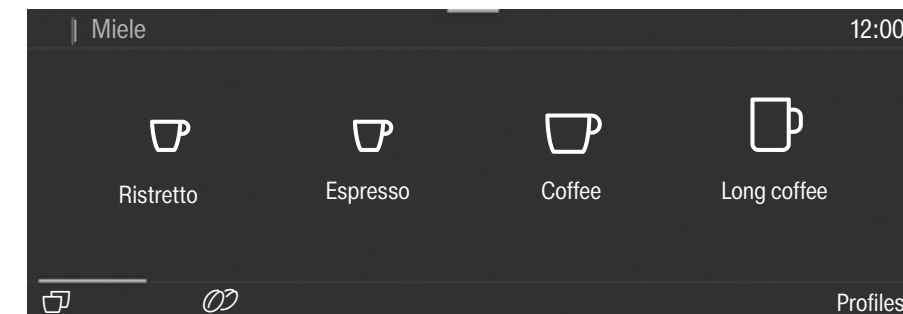

Selecting/ Accessing a menu	<ul style="list-style-type: none"> Touch the entry or value you want in the display.
Scrolling	<ul style="list-style-type: none"> Swipe across the screen. To do this, place your finger on the touch display and swipe it in the direction you want.
Exiting a menu	<ul style="list-style-type: none"> Touch \leftarrow. Alternatively, touch the higher-level menu name within the menu path. Entries made before this which have not been confirmed with OK will not be saved.
Entering numbers	<p>You can enter numbers by swiping and touching the roller or via the numerical keypad.</p> <p>Roller:</p> <ul style="list-style-type: none"> Swipe the roller up or down until the value you want is displayed centrally in orange. Confirm with OK. <p>Numerical keypad:</p> <ul style="list-style-type: none"> Touch the centrally displayed orange value and keep your finger on it until the numerical keypad appears. Select the value you want: as soon as you enter a valid value, OK turns green. Use the \leftarrow arrow to delete the last entered number. Confirm with OK.
Entering letters	<p>Names are entered using a keyboard. It is best to select short names.</p> <ul style="list-style-type: none"> Touch the letters or characters you want. Touch Save.
Displaying the context menu	<p>When you are in certain menus, a context menu can be displayed, e.g. for configuring drinks.</p> <ul style="list-style-type: none"> For instance, you can touch the name of a drink and keep your finger on it until the context menu opens. To close the context menu, touch an area of the display located outside of the menu window.
Show help	<ul style="list-style-type: none"> Context-sensitive help is available for certain functions. The display shows Help. Touch Help to display information in text and pictures.

Drinks overview

Coffee drinks

- Ristretto** is a strong, concentrated espresso. It is prepared with the same amount of coffee as for an espresso but with a lot less water.
- Espresso** is a strong aromatic coffee with a thick hazelnut brown coloured froth – known as the crema – on top.
- Coffee** differs from espresso by the increased amount of water and the roast of the beans.
- Long coffee** is a coffee with considerably more water.
- Long black** is made with hot water and two shots of espresso.
- Caffè Americano** consists of equal proportions of espresso and hot water. The espresso is made first, then the hot water is dispensed into the cup.

Coffee drinks made with milk

- Cappuccino** consists of approx. 2/3 milk froth and 1/3 espresso.
- Latte macchiato** consists of 1/3 each of hot milk, milk froth and espresso.
- Caffè latte** consists of espresso and hot milk.
- Cappuccino italiano** has the same proportions of milk froth and espresso as a cappuccino. The difference is that the espresso is added first and then the milk froth.
- Espresso macchiato** is an espresso with a small amount of milk froth on top.

- Flat white** is a special variety of cappuccino that contains significantly more espresso than milk froth for an intensive coffee aroma.
- Café au lait** is a French style of coffee consisting of coffee and milk froth. Café au lait is usually served in a bowl.

Tea drinks

- (hot water at the optimum temperature)
- White tea
 - Japanese tea
 - Green tea
 - Herbal tea
 - Fruit tea
 - Black tea
 - Chai Latte** is a tea speciality with milk.

Other drinks

- Hot milk
- Milk froth
- Hot water
- Warm water

Pot function

- (3 to 8 cups can be selected)
- Coffee pot
 - Teapot for all types of tea

Description

Exterior view

- On/Off button
- Optical interface (for the Miele Customer Service Department only)
- MobileStart sensor control
- Movement sensor
- "Back" sensor control
- Touch display
- Sensor control
- Door handle
- Height-adjustable central spout with lighting
- Drip tray cover
- Milk flask

Interior view

- Bean container (type A and type C)
- Milk valve
- Height-adjustable central spout with lighting
- Grinder setting
- Bean container (type B)
- Fan outlet
- Water container
- Drip tray with lid
- Brew unit
- Waste container
- Maintenance container
- Receptacles for cleaning and descaling cartridges (including adapters)
- Drip tray

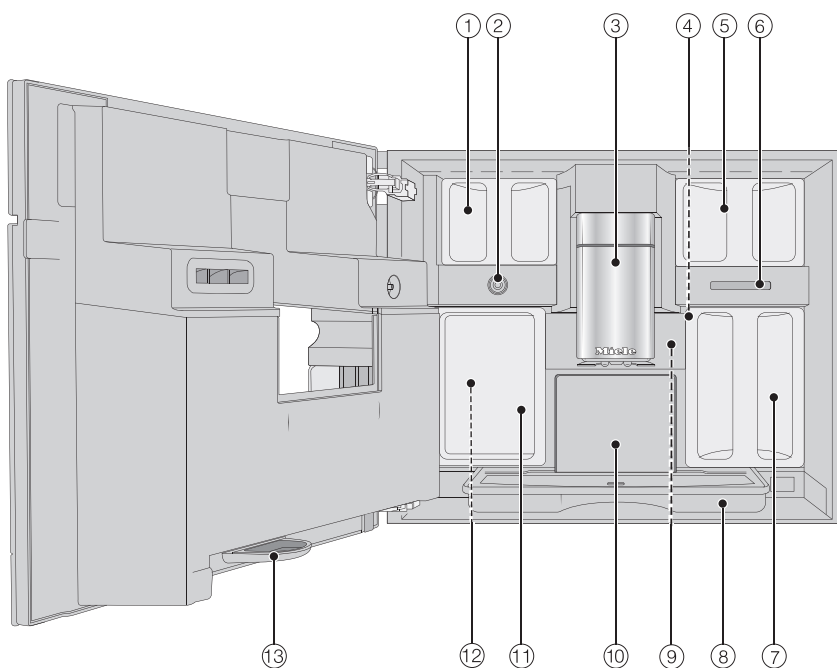
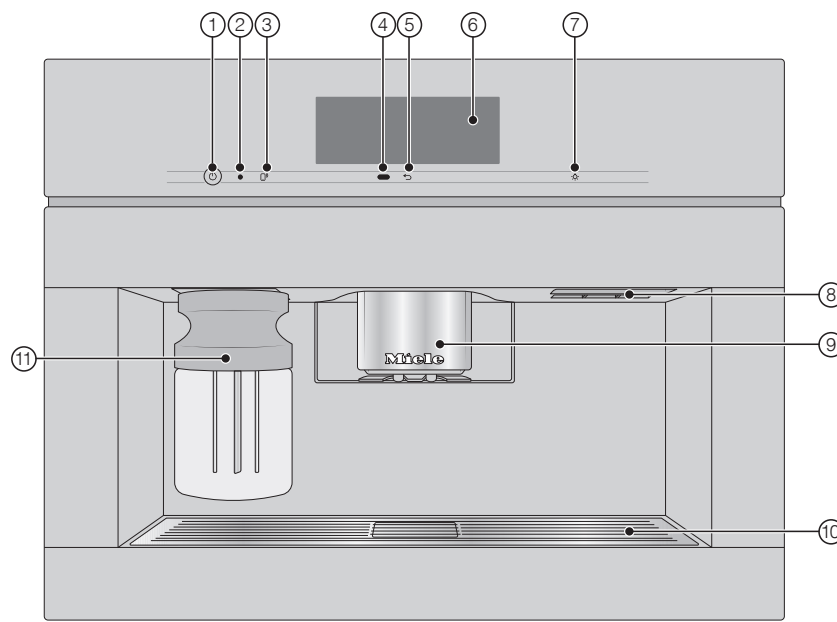

Preparing for use

Filling the water container

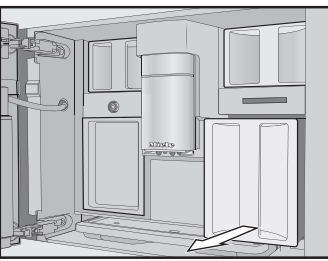
- Open the appliance door.
- 
- Pull the water container forwards to remove it.
 - Fill the water container with fresh, cold tap water up to the "max." mark.
 - Push the water container back into the coffee machine and close the appliance door.

Filling the bean containers

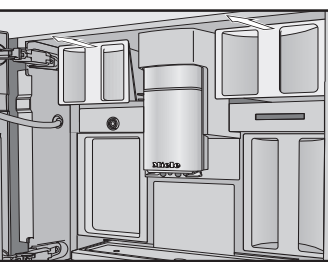
- Only put roasted coffee beans in the bean containers.
- Open the appliance door.
- 
- Pull the bean containers out and take off the lids.
 - Fill the bean containers with coffee beans and put the lids back on the bean containers to seal them.
 - Push the bean containers all the way back into the coffee machine.
 - Close the appliance door.

Making drinks

Making a drink

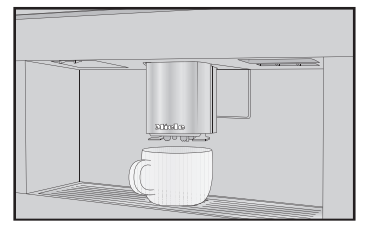
- 
- Place a cup under the central spout.
 - Select a drink.
- Cancelling a drink**
- Touch Stop or Cancel.

DoubleShot

- Select the DoubleShot ☞ function if you would like a particularly strong and aromatic coffee. In this case, more coffee beans will be ground and brewed halfway through the brewing process.
- Touch ☞ whilst making your coffee.

Making two portions

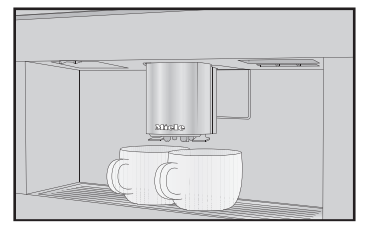
- To fill two cups at the same time:
- 
- Place a cup under each of the coffee dispensers in the central spout.
 - Touch ☞ .
 - Select a drink.

Using the milk flask

- Milk is not cooled in the milk flask. Therefore, place the milk flask in the refrigerator if you are not going to use milk for a while. Good milk froth can only be made with cold milk (< 10 °C).
- Fill the milk flask with milk up to a maximum of 2 cm below the rim.

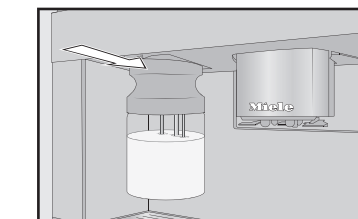

- Push the milk flask back into the coffee machine until it clicks into place. You can now make drinks with milk.

Making tea

- Hot water is heated to the optimum temperature for different types of tea.
- Place the tea filter or the tea bag in the tea cup.
 - Place the tea cup under the central spout.
 - Select the type of tea from the display.
- Hot water will be dispensed into the cup.
- Remove the tea filter or tea bag when the desired brewing time has elapsed.

Tip: You can use the TeaTimer function to start a minute minder when making tea (see the operating instructions).

Pot function

- You can make several cups of coffee or tea one after the other automatically with the Pot function (maximum of 1 litre). This can make up to 8 cups.

Preparing the pot

- The drinks menu is displayed.
- Place a sufficiently large container under the central spout.
 - Select the pot function you want.
 - Select the number of cups you want (3 to 8).
 - Follow the instructions in the display.

Expert mode

- In Expert mode, you can allocate a bean type temporarily and change the portion size while the drink is being made. Expert mode must be activated for this (in the pull-down menu: the word Expert mode is highlighted in orange).

The setting will **not** be saved and will only apply for the current drink.

Allocating bean containers temporarily

- Touch the top edge of the screen and open the pull-down menu.
- Now select the bean container containing the beans you want to use for the current drink.
- To close the menu window, drag it back up to the top.
- Now start making the drink.

Changing the portion size

The portion size can only be changed during the individual preparation stages.

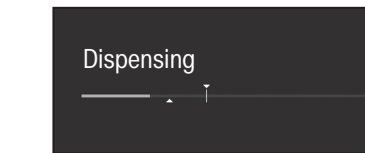

- Touch the bar and adjust the indicator (small triangle) as you wish.

Cleaning and care

Please observe the detailed information on cleaning and care in the operating instructions. Carefully clean the coffee machine regularly.

Recommended cleaning interval	What do I have to clean/maintain?
Every day (at the end of the day)	<ul style="list-style-type: none"> Milk flask and lid Milk valve Water container Drip tray cover Drip tray and waste container
Once a week (more often if heavily soiled)	<ul style="list-style-type: none"> Central spout Cup rim sensor Interior cabinet Brew unit Drip tray Appliance front
Once a month	<ul style="list-style-type: none"> Bean containers
As and when required/after prompt appears in display	<ul style="list-style-type: none"> Milk pipework Degrease the brew unit Descalc the appliance

Cleaning by hand or in the dishwasher

Clean the following by hand only:

- Stainless steel cover of the central spout
- Brew unit
- Bean containers and lids

The following can be cleaned in the dishwasher:

- Drip tray, lid and waste container
- Drip tray cover
- Central spout (without stainless steel cover)
- Milk flask and lid
- Cup rim sensor
- Drip tray
- Maintenance container
- Water container